

FORM No. 1.

Courses and distances up
The river from Herrlock-

- N. 66 W. - 42 ps.
 - N. 40 W. - 8.
 - N. 28 W. - 14.
 - N. 40 W. - 6.
 - N. 51 W. - 8.
 - N. 61 W. - 10.
 - N. 76 W. - 18.
 - N. 60 W. - 12.
 - N. 52 W. - 44.
 - N. 58 W. - 18.
 - N. 71 W. - 21.
 - West - 14.
 - S. 83 W. - 16.
 - S. 79 W. - 64.
 - N. 82 W. - 24.
 - S. 88 W. - 16.
 - S. 75 W. - 34.
 - S. 51 W. - 14.
 - S. 22 W. - 14.
 - S. 3 W. - 20.
 - S. 5 E. - 36.
 - S. 25 E. - 12.
 - S. 3 E. - 22.
 - S. 21 W. - 26.
 - S. 35 W. - 32
-
- 545 ps.

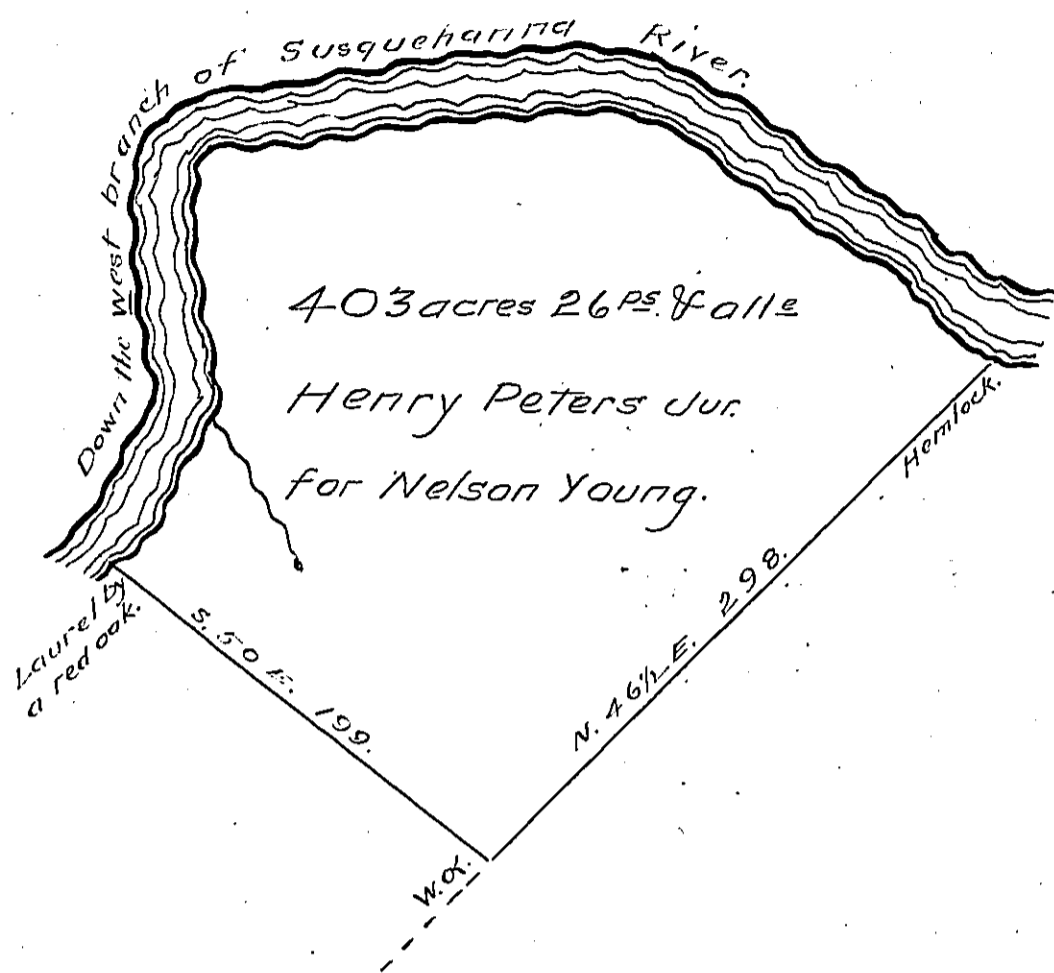

Situate on the South Side of the West Branch of the Susquehanna river in Bell Township Clearfield County Containing four hundred and three acres, twenty six perches and allowance of six per cent, Surveyed for Nelson Young in pursuance of a Warrant granted to Henry Peters jur. dated the 18th day of December 1793.

Oct. 19th 1854.

Thos. Ross C.S.

To J. Porter Brawley Esq.
Surveyor Gen^l.

IN TESTIMONY that the above is a copy of the original remaining on file in the Department of Internal Affairs of Pennsylvania, made conformably to an Act of Assembly approved the 16th day of February, 1833, I have hereunto set my Hand and caused the Seal of said Department to be affixed at Harrisburg, this twenty second day of June 1906.

Isaac R. Brown
Secretary of Internal Affairs.